



**Coopérative Essaada,
Zhun Aissat Moustapha REGHAIA,
Alger - Algérie**

ghecham@codin-consulting.com

T +213 557 23 92 11

SUPPLIER MAKINA is manufacturing in international quality standards according to the developments in design and manufacturing Technologies. Our company is manufacturing in accordance with international quality standards in the direction of development in design and production technologies. We have our machines working in our country and in the world; Product quality, performance, technology, price and after-sales services

In our manufacturing are following machines:

1. Macbuss egg tray machine
2. Single rotary machine
3. Double rotary machine
4. Industrial carpet / EURO pallet / egg tray machine
5. Moulds (aluminum / steel)
6. Hot press (ironing press) (manual / automatic)
7. Hydra pulper
8. Labelling machine
9. Printer



Coopérative Essaada,
Zhun Aissat Moustapha REGHAIA,
Alger - Algérie

ghecham@codin-consulting.com

T +213 557 23 92 11

SEMI OR FULL AUTOMATIC 5000 pcs / hour SINGLE ROTARY EGG TRAY MACHINE COMPLETE LINE OFFER

REQUESTER M GHECHAM ABDELALI

COMPANY CODIN COUNSULTING
Coopérative Essaada, Zhun Aissat Moustapha REGHAIA,
Alger - Algérie

PHONE NO +213 557 239 211

EMAIL ghecham@codin-consulting.com

OFFER SUBJECT Terms & Conditions For Manufacturing Of Egg Tray Production Plant

NAME OF TASK Manufacturing Of Complete Plant For The Production Of Egg Trays

OFFER NO 001



Coopérative Essaada,
 Zhun Aissat Moustapha REGHAIA,
 Alger - Algérie
ghecham@codin-consulting.com
 T +213 557 23 92 11

TERMS AND CONDITIONS

Subject : 5000 pcs/h Egg Tray Production Line Quotation

Line	Pulper, Single Rotary Egg tray machine with 4 lines and Drying line with 8 tiers
Capacity:	5000 pieces per hour
Payment terms	<p>Advance payment of 50 % of the total price shall be paid by means of TT. After 90 days of order confirmation 20 % to be paid. After 180 days of order confirmation %20 of the total price to be paid (after test-start in Denizli and your approval) by means of TT. Dispatch will be Ex – Works / Denizli. 10 % of total total price shall be paid after installation, commisioning and training completed. After transportation completed to customers’ factory; installation and commisioning will be completed (15 days), 15 days production training will be given. During the installation period, 4 persons from buyer’s staff will be working together with our team in order to receive technical and maintenance training (This training is required by your technical staff).</p> <p>The installation, training and consulting for 30 days will be covered by us. Customs, and transportation costs of equipments and logistics will be covered by the buyer. Flight ticket, visa, accomodation, meal expenses of assembling team will be covered by the buyer.</p>
Delivery:	180 DAYS AFTER PREPAYMENT (15 DAYS OPTIONAL TIME WILL BE GIVEN TO MANUFACTURER) – EXWORKS DENIZLI /TURKEY
NOTE	Processes and labor which are out of scope or extras will be charged by means of a supplementary invoice. Daily wages are 220 USD/personnel (consultancy & training).
PROVIDED BY US	Technical support for the egg tray machine and for the production processes
Delays in payment mentioned in the payment terms, will lead to delays in production timing. In this case, we will not be responsible for the delays.	
WARRANTY OF THE EQUIPMENT	<ul style="list-style-type: none"> All mechanical equipment are under warranty for 1 year, except for user errors. Automation system is under warranty for 1 year, except for user errors
PROVIDED BY BUYER	Excavation of plant area, power supply, diesel or natural gas and water will be provided by your side according to the technical specs given in the schematics in order to be able to start the installation.
PULP HOLDING TANKS	10 TONS, 3 are required. (shall be provided by the buyer, because of the transportation costs more than tanks)

LIST OF EQUIPMENTS

1. PULPER

Main Technical Parameters	Picture
<ul style="list-style-type: none"> <input type="checkbox"/> Motor: 45 kw equipped with belt and pulley <input type="checkbox"/> Equipped with waste material discharger and wave breaker • CBM : 6 m³ <input type="checkbox"/> With 6 bladed knife (55-58 HRC). The blades are detachable for easy maintenance <input type="checkbox"/> Vibrator Screening Unit (6 mm hole diameter) <input type="checkbox"/> D type buddy made of 8 mm steel <input type="checkbox"/> Primer painted 	   



SARL CODIN



Coopérative Essaada,
Zhun Aissat Moustapha REGHAIA,
Alger - Algérie

ghecham@codin-consulting.com

T +213 557 23 92 11

VIBRATOR SCREENING UNIT



2. PULP FORMING UNIT

- Forming method: Single Rotary Vacuum Moulding with 4 lines
- Mould Material: Aluminium
- Capacity: 5000 pcs / h for 30 cavity egg tray,
- Octagon type single rotary with 4 lines moulding drum with suited for quick mould change (**around 60 minutes**),
- Bearings (**SKF which is made of German or nochi which is made of Japan**)
- Rotor die lubrication and cleaning system. (Recommended oil type is mobil vatra no:2)
- The octagon machine with 4 lines comes with 32 pcs wired moulds and with 4 pcs transfer moulds
- The moulds will be produced with CNC
- Equipped with stainless mechanical seal
- **Steel or stainless steel body for rotary machine (optional)**





SARL CODIN



**Coopérative Essaada,
Zhun Aissat Moustapha REGHAIA,
Alger - Algérie**

ghecham@codin-consulting.com

T +213 557 23 92 11

Moulds

Material: Aluminum





SARL CODIN



**Coopérative Essaada,
Zhun Aissat Moustapha REGHAIA,
Alger - Algérie**

ghecham@codin-consulting.com

T +213 557 23 92 11

Moulds

Material: Aluminum



Vaccum pump

- Vacuum pump is 75 kw, with water ring and with stainless steel mill (shaft)





SARL CODIN



Coopérative Essaada,
Zhun Aissat Moustapha REGHAIA,
Alger - Algérie

ghecham@codin-consulting.com

T +213 557 23 92 11

3. DRYING FURNACE

- Formation: 4 lines, 8 tiers tunnel type, 18 meter length
- Transportation System: Chain Conveyer System
- Wall thickness 150 mm, isolated with 800 degrees wool stone
- Energy: Natural gas or diesel firing system. □
- Temperature range: 100 °C to 600 °C
- Ventilation: Forced Air Circulation.
- Bi directional air flow dryer zone.
- All Chains shall be equipped with automatic chain oiling system.
- Dryer has a continuous variable speed roller chain tray conveyors that automatically matches the moulding speed.
- Dryer shall be equipped with one burner (diesel or natural gas)
- The transfer of the products in the furnace are made by central weighted galvanized coated or **stainless steel (optional)** pans with holes to provide an easy air circulation.
- The conveyor chain is equipped with holed pins and bigger reels than the diameter of the chain that helps easy moving. Chain type (50 HRC) is pallet chain.
- The chain tension is provided by weights, not with springs.
- The gears of the chain is, made of steel, oil proof and with 2 bearings.
- The furnace is equipped with one circulation fan. The Fan is equipped with water discharger.
- In air discharging chimney there is a steam absorption unit. The hot water, which is gained from the steam, is being transferred to the forming unit to obtain hot water. So that energy saving is provided.
- The furnace has pretensioning capability which helps tensioning the furnace when the temperature gets low or high.
- The side walls of the furnace are equipped with doors with hasp. The doors are sealed with incombustible wick to prevent air leak.

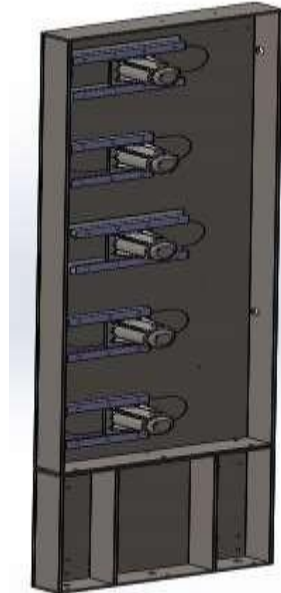



SARL CODIN

Coopérative Essaada,
Zhun Aissat Moustapha REGHAIA,
Alger - Algérie

ghecham@codin-consulting.com

T +213 557 23 92 11

CHAIN PART

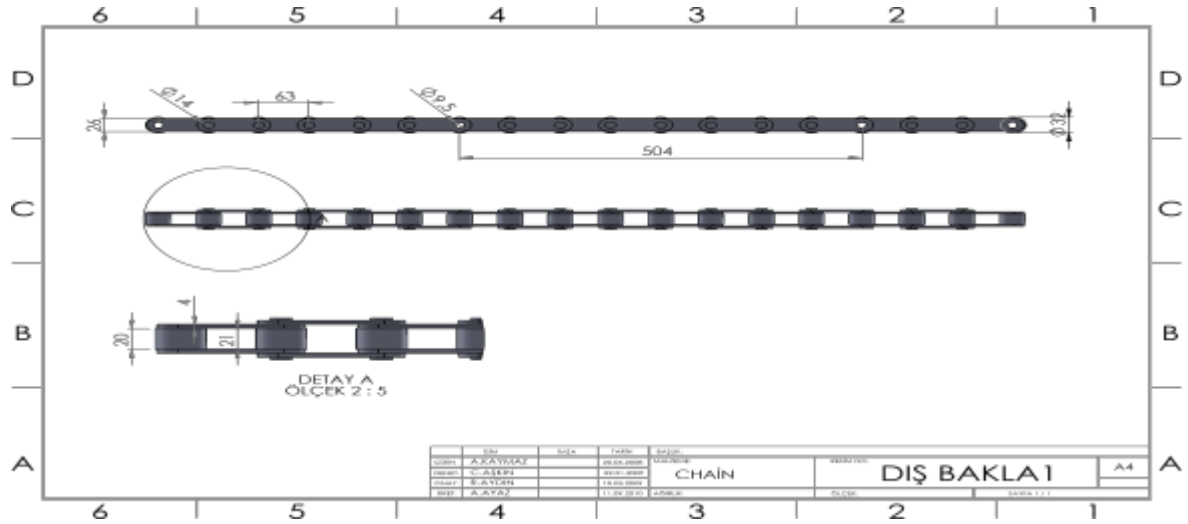

FURNACE ASSEMBLING

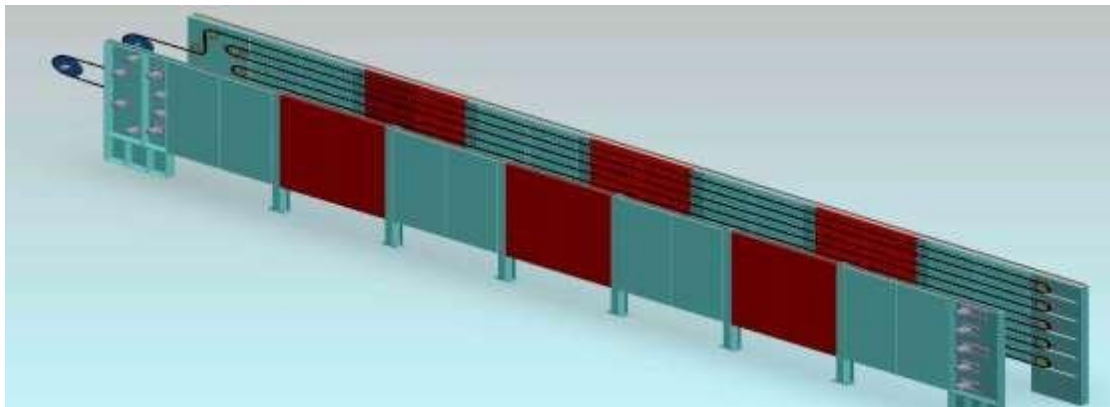
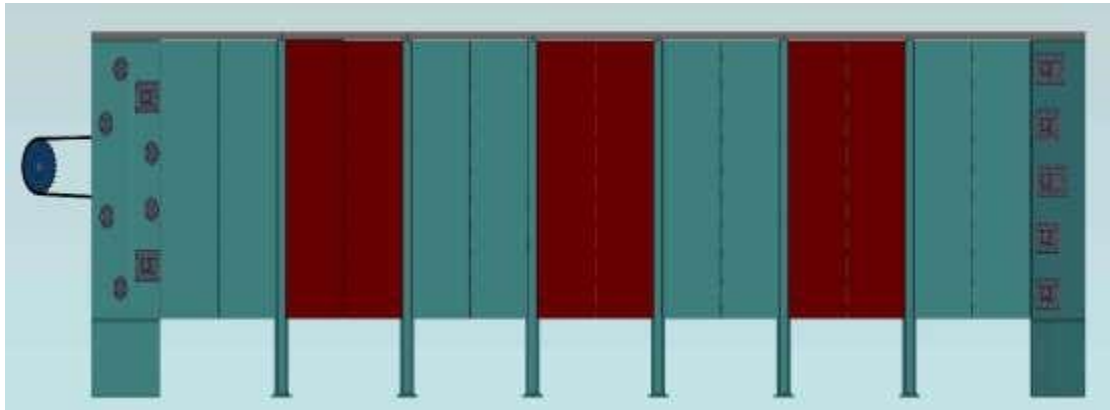



SARL CODIN



Coopérative Essaada,
Zhun Aissat Moustapha REGHAIA,
Alger - Algérie

ghecham@codin-consulting.com

T +213 557 23 92 11

VIEW OF COMPLETE SYSTEM

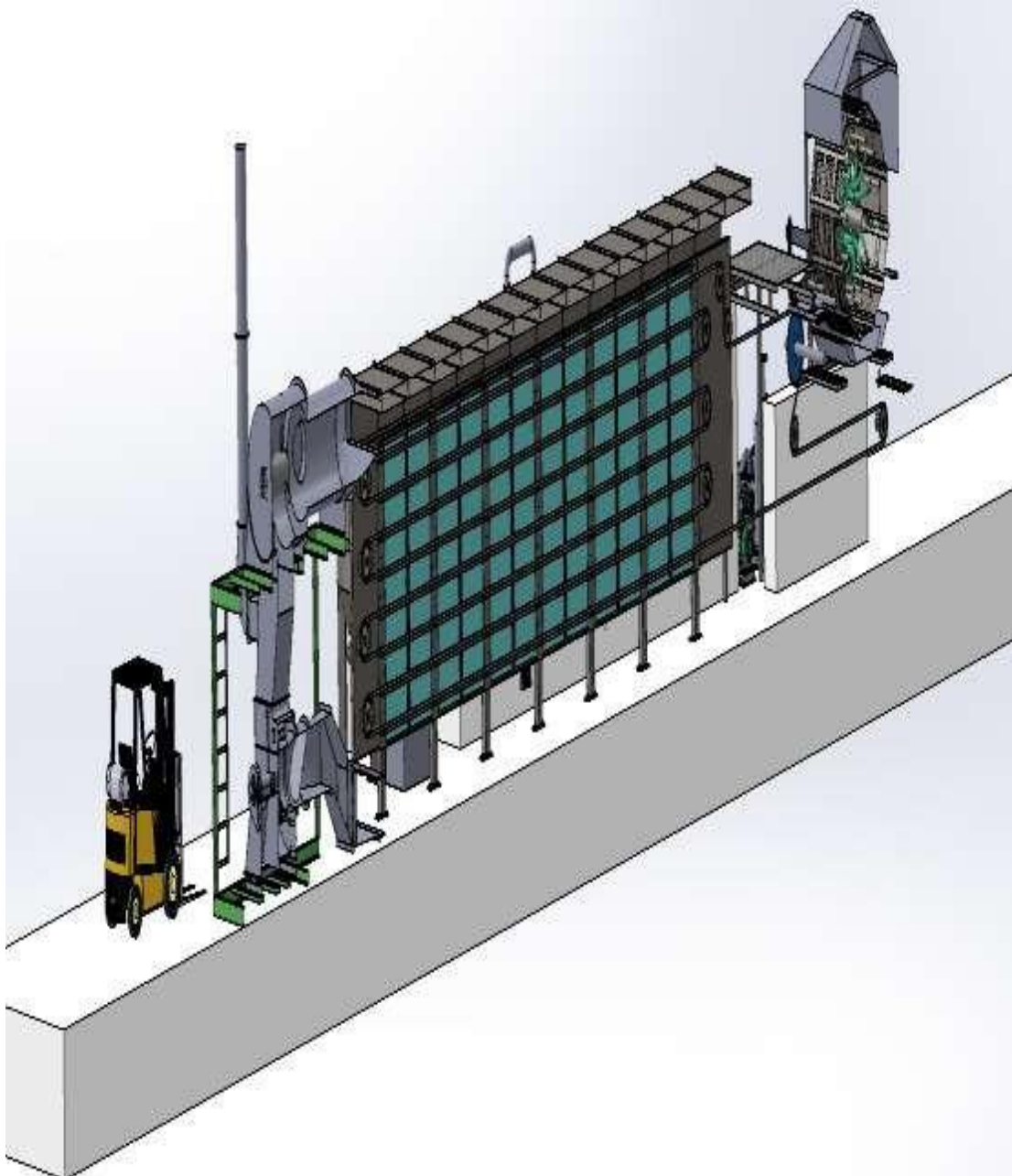



SARL CODIN



Coopérative Essaada,
Zhun Aissat Moustapha REGHAIA,
Alger - Algérie

ghecham@codin-consulting.com

T +213 557 23 92 11

VERY FIRST BEGINNING OF MACHINE MANUFACTURING



AFTER SYSTEM COMPLETED (READY FOR TEXT PRODUCTION)





SARL CODIN

Coopérative Essaada,
Zhun Aissat Moustapha REGHAIA,
Alger - Algérie

ghecham@codin-consulting.com

T +213 557 23 92 11

SPECS OF THE EGG TRAY MACHINE

ASKA_5000 SINGLE ROTARY EGG TRAY MACHINE	17,5	kW	4 Lines flat transfer section octagonal wired section
VACUUM PUMP	75	kW	Made in Turkey
PULPER	45	kW	6 tons
DRYING SYSTEM	37,5	kW	Diesel or Natural gas
	18	m	8 levels
PULP HOLDING TANKS	10	tons	3 are required (will be provided by the buyer)
MIXERS, TRANSMISSION PUMPS, PLATFORMS & PIPING UTILITIES	40	kW	Will be provided by the supplier
MOULDS (4 set)	32	pcs	Wired
	4	pcs	Transfer
Output in product	5.000 PCS / H		
Max. output in kgs	400	kg/h	
Natural gas consumption	85	m ³ /h	
Diesel Consumption	60-65	Lt/h	
Staff requirement	4 – 5	per machine	
Drying system (8 levels, 18 m)	37,5	kW	

NOTE: TOTAL (INCLUDED PRODUCTION LINE) SUGGESTED PLANT IS 1000-1500 sqm



Coopérative Essaada,
Zhun Aissat Moustapha REGHAIA,
Alger - Algérie

ghecham@codin-consulting.com

T +213 557 23 92 11

THE PRODUCTION PROCESS

Raw material:

The main raw material is mainly about the books ,papers,the cultural paper,carton and the leftover material of the tissue paper factory,the carton factory and the printing factory.The more important thing is to reuse the waste paper, protect the environment and get the profit .

Pulp making:

The raw material for making the egg tray-waste paper or carton put into the pulper and with the knives force and the force of the water flow the pulp is prepared ,then the pulp is put into the pulp tank. To make the appearance of the egg tray better and more smooth, the pulp is being filtered with the screening unit into the thick pulp holding tank. That is to get rid of the impurity in the pulp (the plastic film,hemp rope and coarse residue or other materials). After this processing, the pulp is being mixed with water to a certain degree of concentration, then the pulp is transfered to the thin pulp holding tank.

Forming:

The molds sank completely into the pulp,with the pumping made by the vacuum power from the back of the forming molds.The pulp, by the power of the vacuum, will be adhered to the surface of the molds and the water will be pumped out.The water is being transfered back to the pulp pool. The pulp, which is adhered on the surface of the molds on the rotary, is transfered to the transfer moulds. The extra pulp and water, which is left over from the forming machine, is transfered to return tank then sent to the thin pulp tank.

Drying:

The wet base egg trays, is tranfered to the furnace in order to be dried. After drying, just packed and sent to the warehouse.



SARL CODIN



Coopérative Essaada,
Zhun Aissat Moustapha REGHAIA,
Alger - Algérie

ghecham@codin-consulting.com

T +213 557 23 92 11

SAMPLE PRODUCTS OUR MACHINE CAN PRODUCE





SARL CODIN



Coopérative Essaada,
Zhun Aissat Moustapha REGHAIA,
Alger - Algérie

ghecham@codin-consulting.com

T +213 557 23 92 11





SARL CODIN

Coopérative Essaada,
Zhun Aissat Moustapha REGHAIA,
Alger - Algérie

ghecham@codin-consulting.com

T +213 557 23 92 11

PRICING

PULP FORMING UNIT	Single rotary 4 lines octagon pulp molding machine,
PULPER	Pulp chopping unit
DRYING UNIT	Drying furnace (8 tiers, 18 m)
TOTAL PRICE	
	308.000,00 USD Exworks/Denzli
OPTIONAL EQUIPMANT AS PER CUSTOMER'S REQUEST	
FULL AUTOMATION SYSTEM	22.000,00 USD
STAILESS STEEL ROTARY MACHINE BODY AND STAINLESS STEEL TRANSFER PANS IN THE FURNACE	44.000,00 USD
EXTRA MOULD SET (1 SET INCLUDES 8 WIRED AND 1 TRANSFER MOULD)	6 800,00 USD
NOTE	The machine equipment pricing and system specs are as given above, compressor is not included in pricing and should be purchased from the target country.
Moulds	The system includes 4 sets of moulds. (4 sets wired molds and 1 set transfer mold) The mould sizes will be identified by the buyer.